

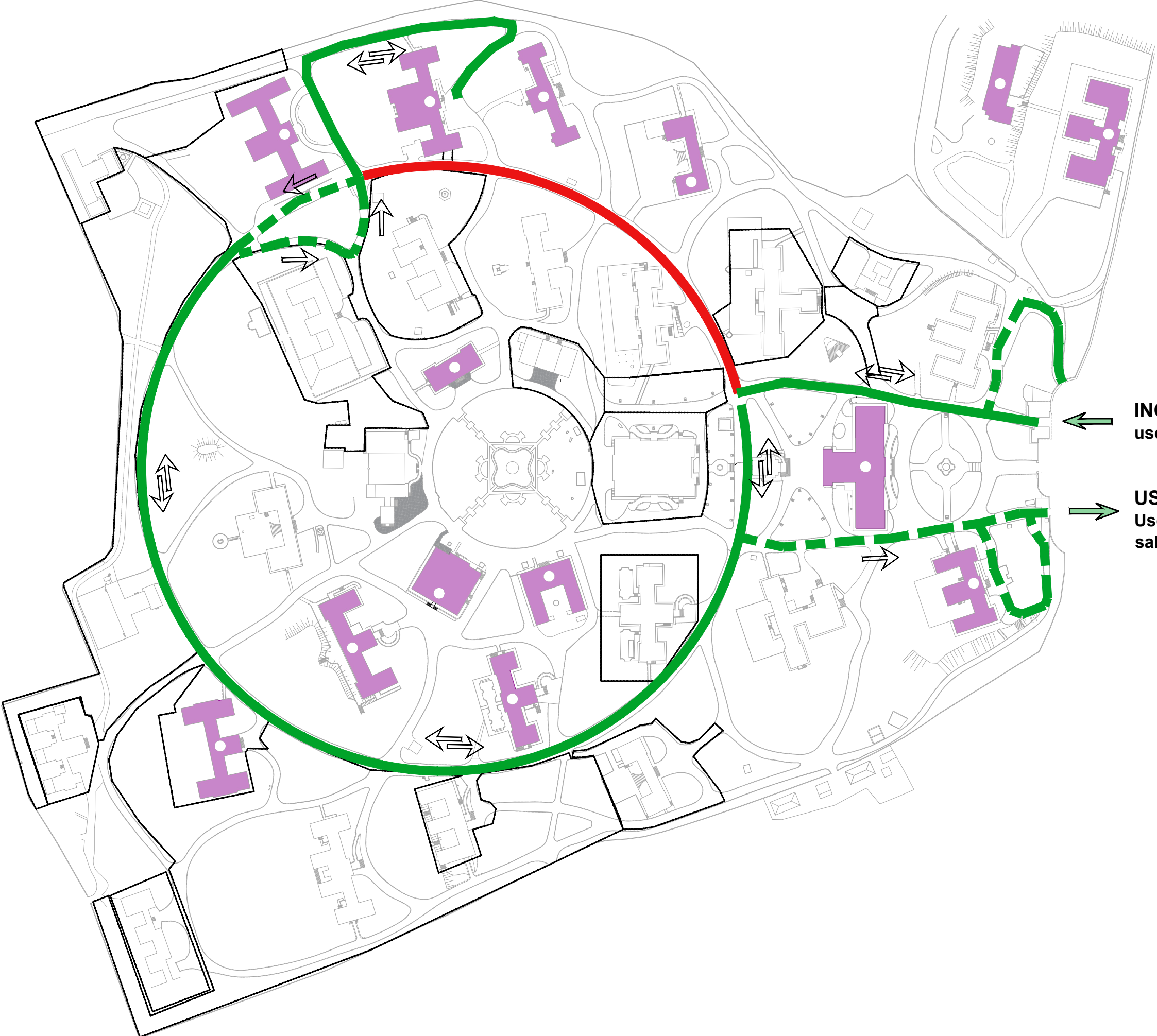





**VIABILITA' DI VEICOLARE**  
**11 e 12 Aprile 2026**



**INGRESSO CARRABILE**  
uscita per periodo notturno

**USCITA CARRABILE**  
Uscita periodo diurno  
sabato fino alle ore 14.00

-  Viabilità a SENSO UNICO
-  VIABILITA' A DOPPIO SENSO
-  Tratto di anello interdetto
-  Padiglioni in esercizio
-  Area di cantiere non accessibile